



### 1. Application:

**AWO385** metal enclosure is designed for mounting built-in power supplies of the following series:

- **LRS**-35-xx, LRS-50-xx, LRS-75-xx, LRS-100-xx, LRS-150-xx.
- **RS**-15-xx, RS-25-xx, RS-35-xx, RS-50-xx, RS-75-xx, RS100-xx, RS150-xx.
- **PS**-15xxxx, PS-25xxxx, PS-40xxxx, PS-60xxxx, PS-100xxxx, PS-150xxxx, PS-200xxxx.
- **RSP**-100-xx, RSP- 150-xx, RSP-200-xx, RSP-320-xx, RSP-500-xx.

The enclosure is made of steel with a thickness of 0,7mm, in white color RAL9003. It is equipped with a set of M3x4 screws - 4 pieces and M4x4 screws - 4 pieces - for mounting the power supply.

### 2. Installation:

The enclosure should be mounted by a qualified installer, holding relevant permits and licenses (applicable and required for a given country) for 230V/AC and low-voltage installations.

The housing can be mounted inside, at a temperature range from -10°C up to +40°C.

### 3. Technical parameters

Enclosure: IP	<b>IP20</b>
Application	<b>indoor</b>
Operating temperature	<b>-10°C ÷ 40°C</b>
External dimensions of the enclosure: External dimensions of the front panel:	<b>W=176, H=276, D+D<sub>1</sub>=62+8 [ +/- 2mm ] W<sub>1</sub>=180, H<sub>1</sub>=280 [ +/- 2mm ]</b>
Locking	<b>Cylindrical screw x1</b>
Net weight	<b>~0.90 [kg]</b>
Gross weight	<b>~1.05 [kg]</b>
Finish	<b>DC01 sheet, thickness: 0,7mm Corrosion protection Color: RAL 9003 (white)</b>
Notes	<b>The enclosure includes a set of M3x4 screws – 4 pieces and M4x4 screws - 4 pieces Distance from the wall 8mm</b>

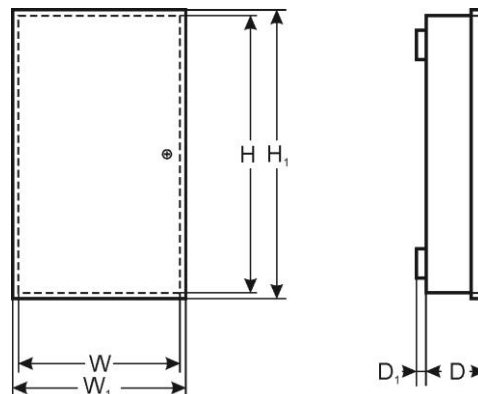

#### Pulsar

Siedlec 150, 32-744 Łapczyca, Poland  
Tel. (+48) 14-610-19-40, Fax. (+48) 14-610-19-50  
e-mail: [biuro@pulsar.pl](mailto:biuro@pulsar.pl), [sales@pulsar.pl](mailto:sales@pulsar.pl)  
http:// [www.pulsar.pl](http://www.pulsar.pl), [www.zasilacze.pl](http://www.zasilacze.pl)